

PAVERS

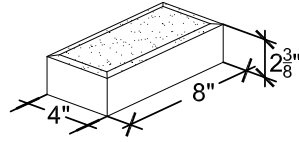

PATTERN PLAN

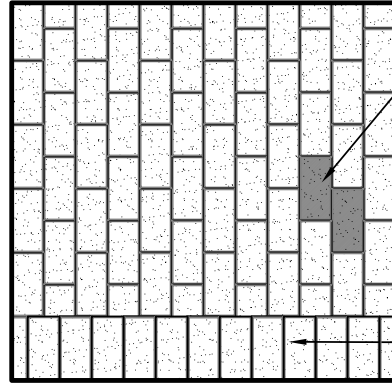

BRICK STONE RUNNING BOND PATTERN  
 RED RIVER HARDSCAPES CONCRETE PAVERS  
 BEGIN SETTING PAVERS ON THE SAND AT THE  
 LOWEST POINT OF THE AREA (IF THERE IS A  
 SLOPE) OR AT A SINGLE-CORNER STARTING  
 POINT. WALK ON THE PAVERS AS YOU LAY  
 THEM, NOT ON THE SCREEDED SAND.

FILL THE AREA WITH AN INTERLOCKING  
 PATTERN UP TO THE EDGE OF THE RESTRAINT.

SOLDIER COURSE PAVER BORDER

AXONOMETRIC

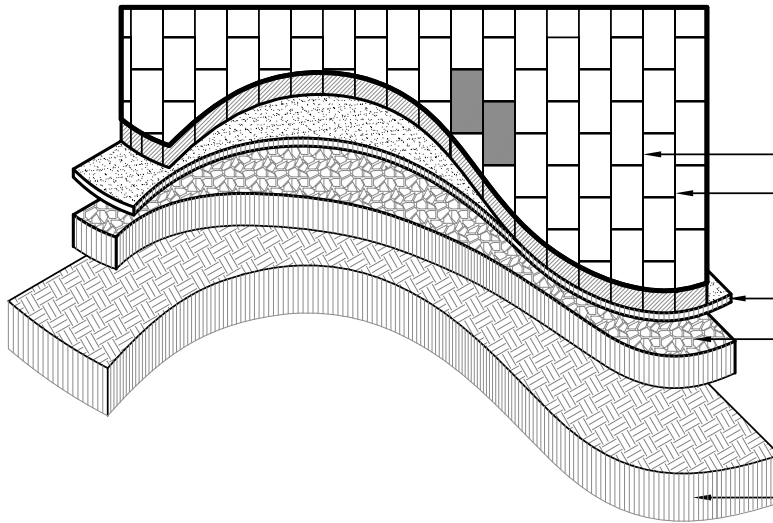

SPECIFICATIONS AND DETAILS FOR BASE  
 COMPACTION AND SUBSURFACE DRAINAGE ARE  
 SITE SPECIFIC AND SHALL PROVIDED BY CIVIL  
 ENGINEER/ GEOTECHNICAL.

FILL JOINTS W/ ASTM C-33 CONCRETE SAND

BRICK STONE RUNNING BOND PATTERN  
 RED RIVER HARDSCAPES CONCRETE PAVERS

1" SAND SETTING BED

6" COMPACTED STONE BASE FOR  
 RESIDENTIAL APPLICATIONS

8" FOR VEHICULAR APPLICATIONS  
 COMPACT IN 3" LIFTS

COMPACTED SUBGRADE  
 SEE SPECIFICATIONS

SECTION

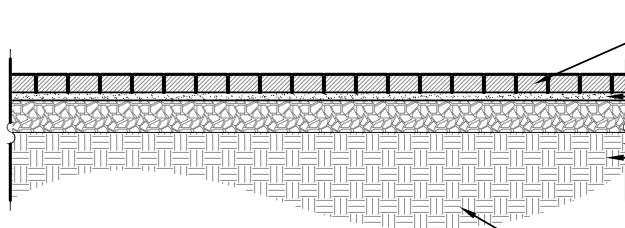

BRICK STONE RUNNING BOND PATTERN  
 RED RIVER HARDSCAPES CONCRETE PAVERS

1" SAND SETTING BED

6" COMPACTED STONE BASE FOR RESIDENTIAL  
 APPLICATIONS

8" FOR VEHICULAR APPLICATIONS COMPACT IN  
 3" LIFTS PLACE 1% SURFACE SLOPE AWAY FROM  
 ANY STRUCTURES

COMPACTED SUBGRADE. SEE  
 SPECIFICATIONS

# Red River Hardscapes Brick Stone Pavers . RUNNING BOND PATTERN

