

PAVERS

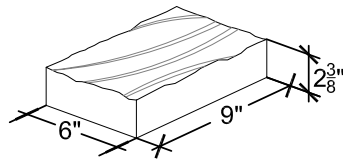

PATTERN PLAN

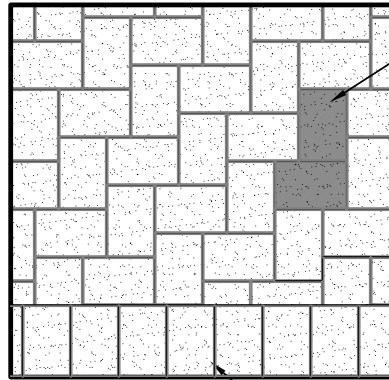

PRINCETON HERRINGBONE PATTERN
RED RIVER HARDSCAPES CONCRETE PAVERS

BEGIN SETTING PAVERS ON THE SAND AT THE LOWEST POINT OF THE AREA (IF THERE IS A SLOPE) OR AT A SINGLE-CORNER STARTING POINT. WALK ON THE PAVERS AS YOU LAY THEM, NOT ON THE SCREEDED SAND.

FILL THE AREA WITH AN INTERLOCKING PATTERN UP TO THE EDGE OF THE RESTRAINT. CUT OUTER EDGE PAVERS TO FIT SNUGLY INTO THE AREA. A SOLDIER COURSE OF PAVERS IS RECOMMENDED.

SOLDIER COURSE PAVES BORDER

AXONOMETRIC

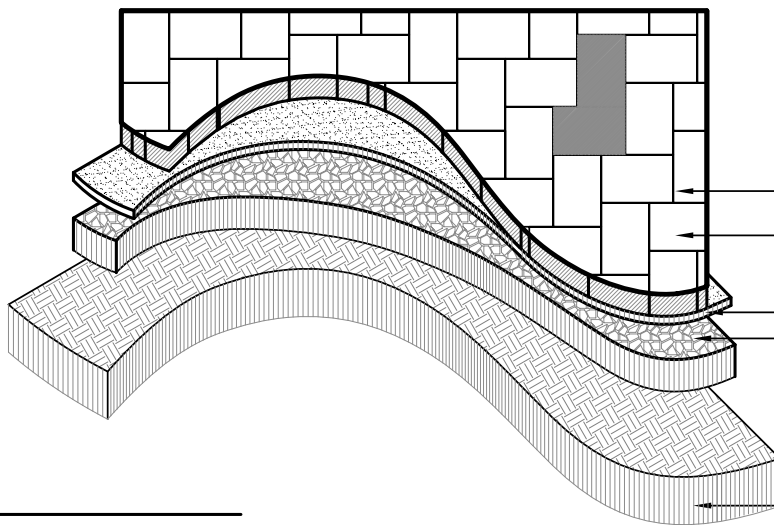

SPECIFICATIONS AND DETAILS FOR BASE COMPACTION AND SUBSURFACE DRAINAGE ARE SITE SPECIFIC AND SHALL PROVIDED BY CIVIL ENGINEER/ GEOTECHNICAL.

FILL JOINTS W/ ASTM C-33 CONCRETE SAND

PRINCETON HERRINGBONE PATTERN
RED RIVER HARDSCAPES CONCRETE PAVERS

1" SAND SETTING BED
6" COMPACTED STONE BASE FOR RESIDENTIAL APPLICATIONS

8" FOR VEHICULAR APPLICATIONS
COMPACT IN 3" LIFTS

COMPACTED SUBGRADE
SEE SPECIFICATIONS

SECTION

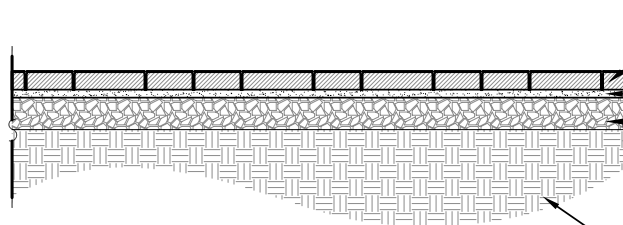

PRINCETON HERRINGBONE PATTERN
RED RIVER HARDSCAPES CONCRETE PAVERS

1" SAND SETTING BED
6" COMPACTED STONE BASE FOR RESIDENTIAL APPLICATIONS

8" FOR VEHICULAR APPLICATIONS COMPACT IN 3" LIFTS
PLACE 1% SURFACE SLOPE AWAY FROM ANY STRUCTURES
COMPACTED SUBGRADE
SEE SPECIFICATIONS

Red River Hardscapes

Princeton Pavers . 6" x 9" HERRINGBONE PATTERN

